

**TRANSTECNO**<sup>®</sup>  
the modular gearmotor

**Ott** Antriebstechnik  
Standardisierte Individualität

The gearmotors  
for car wash equipment

# Car-Wash Tecno

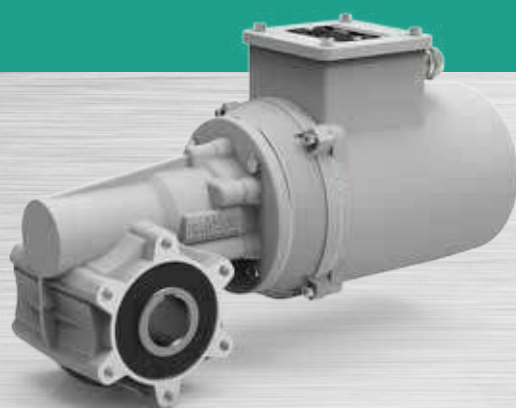
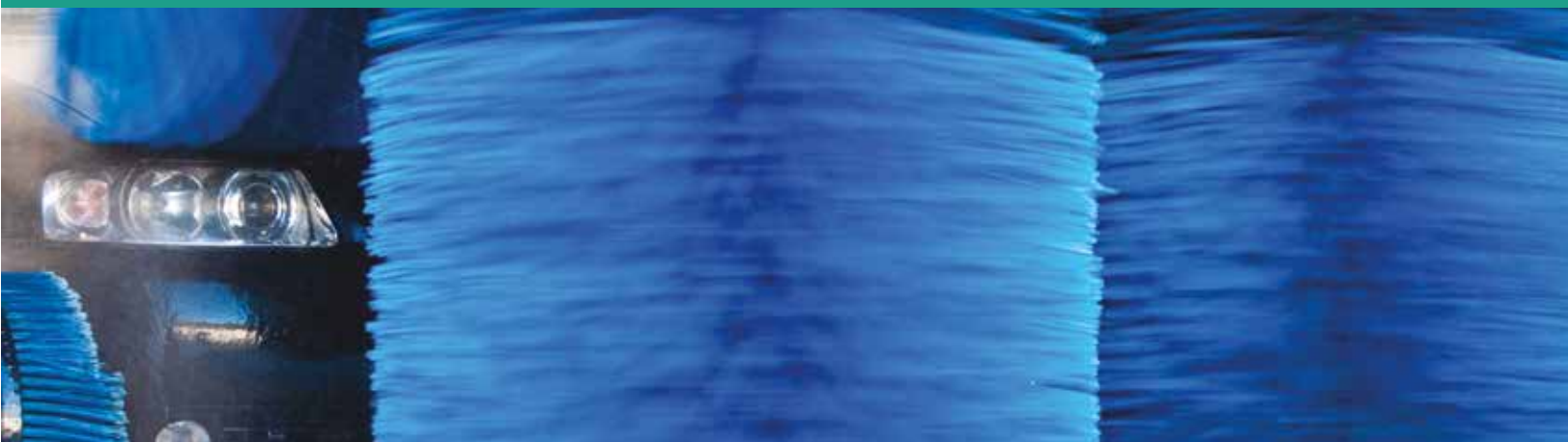

2017



<b>Indice</b>	<b>Index</b>	Pagina Page
<b>CWT050-CWTS050</b>	<b><i>CWT050-CWTS050</i></b>	
Caratteristiche Tecniche	<i>Technical features</i>	2
Designazione	<i>Classification</i>	3
Lubrificazione	<i>Lubrication</i>	3
Simbologia	<i>Symbols</i>	4
Dati tecnici	<i>Technical data</i>	4
Motori Applicabili	<i>IEC adapters</i>	5
Dimensioni	<i>Dimensions</i>	5

## Caratteristiche Tecniche

## Technical features

Le caratteristiche principali dei riduttori a vite senza fine della serie CWT050-CWTS050 sono:

- Elevata modularità grazie ai diversi kit di entrata;
- Elevata robustezza in un riduttore di dimensioni compatte;
- Albero cavo di uscita in acciaio inox per versione CWT; albero di uscita integrato in acciaio con zincatura a caldo (o acciaio inox a richiesta) per versione CWTS;
- Guarnizione stagna tra flangia entrata e motore;
- Elevato numero di rapporti disponibili;
- Lubrificazione permanente con olio sintetico viscosità 320 ( -35°C / +50°C );
- Carcassa e flange in pressofusione di alluminio speciale anticorrosione non verniciato;
- Paraolio di uscita a doppio labbro standard o a cassetta su CWT;
- Paraolio di uscita a cassetta su CWTS.

The main features of the CWT050-CWTS050 wormgear-boxes range are:

- High degree of modularity thanks to a wide selection of input kits;
- Robust, compact size gearbox;
- Hollow output shaft made of stainless steel for CTW; integrated output shaft made of galvanized steel (or stainless steel on request) for CTWS
- Waterproof gasket between input flange and motor;
- Many ratios available;
- Permanent syntetic oil long-life lubrication (viscosity 320; -35°C / +50°C );
- Uncoated anticorrosive die-cast aluminum housing and input flanges
- Standard output double lip oil seals, or cassette seals on CWT;
- Output cassette seal on CWTS.

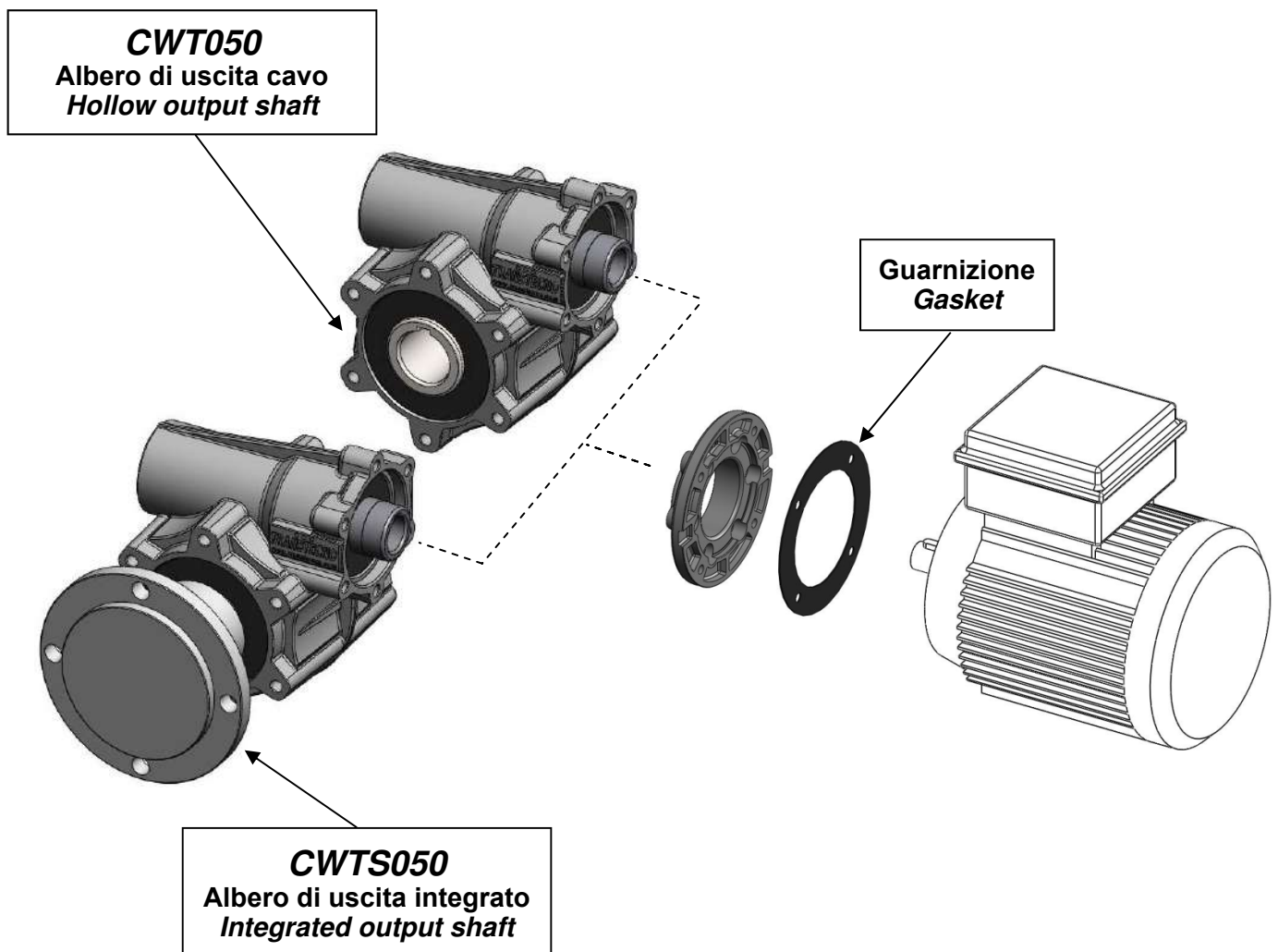

## Designazione

## Classification

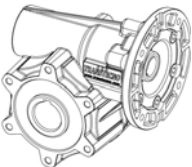
Riduttore / Gearbox				
CWT	050	30	80B14	S
Tipo Type	Grandezza Size	Rapporto Ratio	Flangia entrata Input flange	Paraolio uscita Output seal
	<b>050</b>	Vedi tabelle See tables	<b>71B5</b> <b>71B14</b> <b>80B5</b> <b>80B14</b>	<b>S</b> (standard) <b>C</b> (cassette)

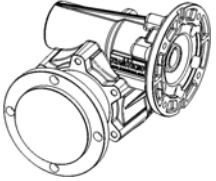
Riduttore / Gearbox						
CWTS	050	30	80B14	O1	G	D
Tipo Type	Grandezza Size	Rapporto Ratio	Flangia entrata Input flange	Albero uscita integrato Integrated out- put shaft	Materiale albero uscita Output shaft Material	Lato albero uscita Output shaft side
	<b>050</b>	Vedi tabelle See tables	<b>71B5</b> <b>71B14</b> <b>80B5</b> <b>80B14</b>	<b>O1</b> <b>O2</b> <b>O3</b> ...	<b>G</b> (acciaio zincato) (galvanized steel) <b>X</b> (acciaio inox) (stainless steel)	<b>D</b> <b>S</b>

Lato albero uscita / Output shaft side

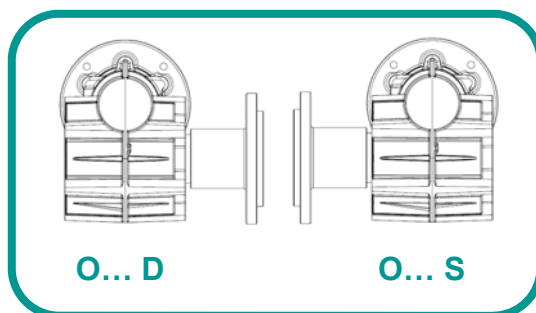

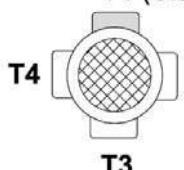
Motori / Motors				
0,75kW	4p	3ph	50Hz	T1
Potenza Power	Poli Poles	Fasi Phases	Frequenza Frequency	Pos. Morsettiera Terminal box pos.
Vedi tabelle See tables	<b>4p</b>	<b>3ph</b>	<b>50Hz</b>	<b>T1 (Std)</b> 

## Lubrificazione

## Lubrication

I riduttori CWT050-CWTS050 sono forniti completi di lubrificante sintetico viscosità 320, possono essere installati in qualunque posizione di montaggio e non necessitano di manutenzione.

Permanent synthetic oil long-life lubrication (viscosity grade 320) makes it possible to use the CWT050-CWTS050 in all mounting positions; for this reason they do not require maintenance.

**Simbologia**

**Symbols**

$i$	Rapporto di riduzione / <i>Ratio</i>
$P_1$ [ kW ]	Potenza in ingresso / <i>Input power</i>
$M_2$ [ Nm ]	Coppia in uscita / <i>Output torque</i>
$sf$	Fattore di servizio / <i>Service factor</i>
$n_2$ [ rpm ]	Velocità in uscita / <i>Output speed</i>

**Dati tecnici**

**Technical data**

$P_1$ [ kW ]	$n_2$ [ rpm ]	$M_2$ [ Nm ]	$sf$	$i$	CWT	IEC
-----------------	------------------	-----------------	------	-----	-----	-----

**0,25**

<b>71B4</b> (1400rpm)	<b>187</b>	11	7,1	7,5	<b>CWT050</b>	B5/B14
	<b>140</b>	14	5,7	10		B5/B14
	<b>127</b>	16	5,0	11		B5/B14
	<b>108</b>	18	3,9	13		B5/B14
	<b>93</b>	21	3,9	15		B5/B14
	<b>88</b>	22	3,7	16		B5/B14
	<b>70</b>	27	2,7	20		B5/B14
	<b>56</b>	32	2,2	25		B5/B14
	<b>47</b>	37	2,4	30		B5/B14
	<b>35</b>	46	1,7	40		B5/B14
	<b>33</b>	48	1,5	43		B5/B14
	<b>28</b>	54	1,3	50		B5/B14
	<b>27</b>	55	1,3	52		B5/B14
	<b>23</b>	61	1,1	60		B5/B14
<b>18</b>	74	0,8	80	B5/B14		
<b>14</b>	80	0,7	100	B5/B14		

**0,37**

<b>71B4</b> (1400rpm)	<b>187</b>	16	4,8	7,5	<b>CWT050</b>	B5/B14
	<b>140</b>	21	3,8	10		B5/B14
	<b>127</b>	23	3,4	11		B5/B14
	<b>108</b>	27	2,6	13		B5/B14
	<b>93</b>	31	2,6	15		B5/B14
	<b>88</b>	33	2,5	16		B5/B14
	<b>70</b>	40	1,8	20		B5/B14
	<b>56</b>	48	1,5	25		B5/B14
	<b>47</b>	55	1,6	30		B5/B14
	<b>35</b>	68	1,1	40		B5/B14
	<b>33</b>	72	1,0	43		B5/B14
	<b>28</b>	80	0,9	50		B5/B14
	<b>27</b>	81	0,9	52		B5/B14
	<b>23</b>	91	0,8	60		B5/B14

$P_1$ [ kW ]	$n_2$ [ rpm ]	$M_2$ [ Nm ]	$sf$	$i$	CWT	IEC
-----------------	------------------	-----------------	------	-----	-----	-----

**0,55**

<b>71C4</b> (1400rpm)	<b>187</b>	24	3,2	7,5	<b>CWT050</b>	B5/B14
	<b>140</b>	32	2,6	10		B5/B14
	<b>127</b>	35	2,3	11		B5/B14
	<b>108</b>	40	1,8	13		B5/B14
	<b>93</b>	46	1,8	15		B5/B14
	<b>88</b>	49	1,7	16		B5/B14
	<b>70</b>	59	1,2	20		B5/B14
	<b>56</b>	71	1,0	25		B5/B14
	<b>47</b>	81	1,1	30		B5/B14
	<b>35</b>	101	0,8	40		B5/B14
	<b>33</b>	106	0,7	43		B5/B14

**0,75**

<b>80B4</b> (1400rpm)	<b>187</b>	33	2,4	7,5	<b>CWT050</b>	B5/B14
	<b>140</b>	43	1,9	10		B5/B14
	<b>127</b>	47	1,7	11		B5/B14
	<b>108</b>	55	1,3	13		B5/B14
	<b>93</b>	63	1,3	15		B5/B14
	<b>88</b>	66	1,2	16		B5/B14
	<b>70</b>	81	0,9	20		B5/B14
	<b>56</b>	97	0,7	25		B5/B14
	<b>47</b>	111	0,8	30		B5/B14

**1,1**

<b>80C4</b> (1400rpm)	<b>187</b>	49	1,6	7,5	<b>CWT050</b>	B5/B14
	<b>140</b>	64	1,3	10		B5/B14
	<b>127</b>	69	1,1	11		B5/B14
	<b>108</b>	81	0,9	13		B5/B14
	<b>93</b>	92	0,9	15		B5/B14
	<b>88</b>	97	0,8	16		B5/B14

Verificare che la coppia  $M_2$  utilizzata non ecceda il valore indicato nelle caselle in grigio  
 Please check that the output torque  $M_2$  does not exceed the value in grey areas

## Motori applicabili

## IEC Motor adapters

	IEC	N	M	P	D	i														
						7.5	10	11	13	15	16	20	25	30	40	43	50	52	60	80
CWT050	71B5	110	130	160	14															
	71B14	70	85	105																
	80B5	130	165	200	19															
	80B14	80	100	120																

 Costruito su richiesta  
Built on request

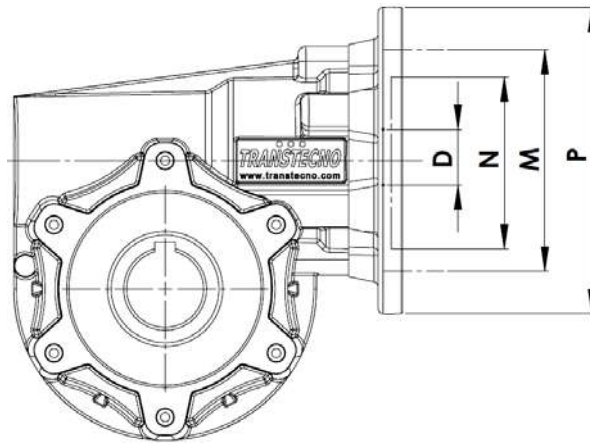

## Dimensioni

## Dimensions

### CWT050...

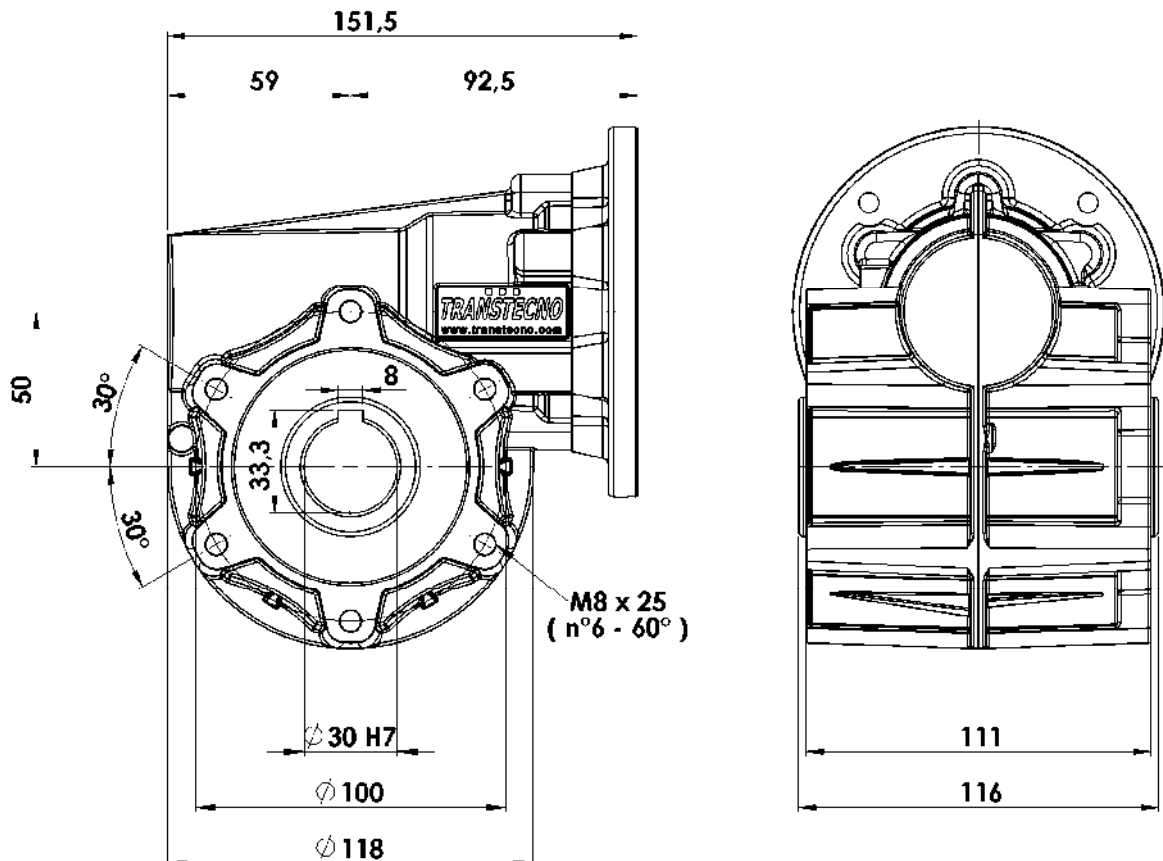

**Dimensioni**

**Dimensions**

**CWTS050... O... D**

**CWTS050... O... S**

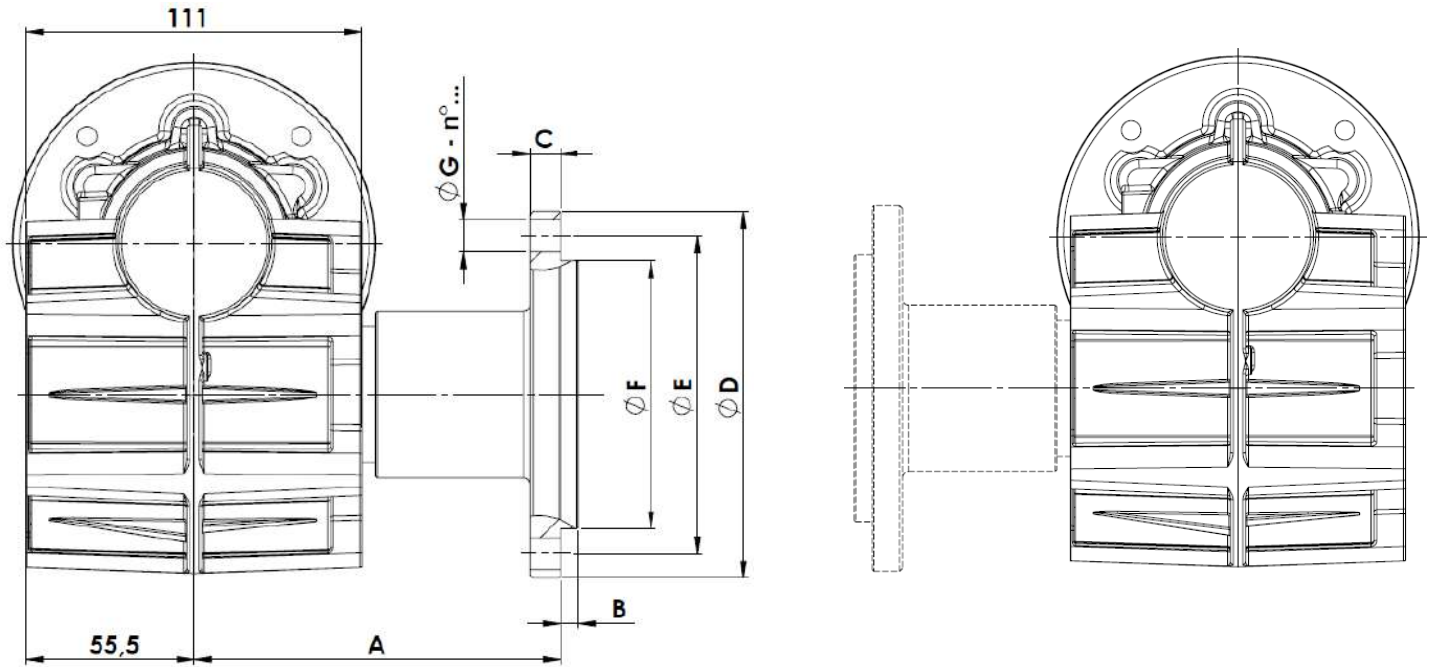

**Nota:** Alberi di uscita integrati eseguiti su richiesta dei clienti .  
**Note:** Integrated output shafts customized upon request.

Dimensioni / Dimensions							CWT050
A	B	C	ØD	ØE	ØF	ØG - n°...	
105	6	10	121	105	88,4	10,5 - n°4	O1
...	...	...	...	...	...	...	O...



**MA TRANSTECNO SAPI DE CV**  
 Av. Mundial # 176, Parque Industrial  
 JM Apodaca, Nuevo León,  
 C.P. 66600  
 MÉXICO  
 T +52 8113340920  
 info@transtecno.com.mx  
 www.transtecno.com.mx



**TRANSTECNO SRL**  
 Via Caduti di Sabbiano, 11/D-E  
 40011 Anzola dell'Emilia (BO)  
 ITALY  
 T+39 051 64 25 811  
 F +39 051 73 49 43  
 sales@transtecno.com  
 www.transtecno.com



**HANGZHOU TRANSTECNO POWER TRANSMISSIONS CO; LTD**  
 Changlian Road, Fengdu Industry zone,  
 Pingyao Town Yuhang Area,  
 Hangzhou, 311115 - CHINA  
 T +86 571 86 92 02 60  
 F +86 571 86 92 18 10  
 info-china@transtecno.com  
 www.transtecno.cn



**TRANSTECNO USA LLC**  
 5440 S.W. 156th Place Miami,  
 FL 33185 - USA  
 Tel: +1 (305) 220-4423  
 Fax: +1 (305) 220-5945  
 usaoffice@transtecno.com



**TRANSTECNO BV**  
 De Stuwdam, 43 - 3815 KM Amersfoort  
 NETHERLANDS  
 Tel: +31(0) 33 45 19 505  
 Fax: +31(0) 33 45 19 506  
 info@transtecno.nl  
 www.transtecno.nl



**SALES OFFICE GUANGZHOU**  
 Room 401A, LeTian Building, No.188 TangAn Road,  
 Tianhe District, Guangzhou City, 510665 - CHINA  
 Tel: + 86 131 85 00 16 27  
 Fax: + 86 571 86 92 18 10  
 guangzhouoffice@transtecno.com



**SALES OFFICE BRAZIL**  
 Rua Dr. Freire Alemão 155 / 402 - CEP. 90450-060  
 Auxiliadora Porto Alegre RS - BRAZIL  
 Tel: +55 51 3251 5447  
 Fax: +55 51 3251 5447  
 Mobile: +55 51 811 45 962  
 braziloffice@transtecno.com  
 www.transtecno.com.br



**TRANSTECNO IBÉRICA**  
 THE MODULAR GEARMOTOR, S.A.  
 C/Enginy, 2 Nave 6  
 08850 Gavà (Barcelona) - SPAIN  
 Tel: +34 931 598 950  
 info@transtecno.es  
 www.transtecno.es



**SALES OFFICE INDIA**  
 A/10, Anagha, S.N. Road, Mulund (W) Mumbai  
 400080 - INDIA  
 Tel: +91 982 061 46 98  
 Fax-Italy: +39 051 733 904  
 indiaoffice@transtecno.com



**SALES OFFICE FRANCE**  
 12 Impasse des Mûriers  
 38300 Ruy - FRANCE  
 Tel: +33 (0) 6 85 12 09 87  
 Fax-Italy: +39 051 733 904  
 franceoffice@transtecno.com  
 www.transtecno.fr



**SALES OFFICE SOUTH KOREA**  
 D-304 Songdo BRC Smart Valley 30, Songdomirae-ro,  
 Yeonsu-gu, Incheon, 406-840 - SOUTH KOREA  
 Tel: +82 70 8288 2107  
 Fax: +82 32 815 2107  
 Mobile: +82 10 5094 2107  
 koreaoffice@transtecno.com



**SALES OFFICE OCEANIA**  
 44 Northview drive, Sunshine west 3020  
 Victoria - AUSTRALIA  
 Tel: +61 03 9312 4722  
 Fax: +61 03 9312 4714  
 Mobile: +61 0438 060 997  
 oceaniaoffice@transtecno.com  
 www.transtecno.com.au

**TRANSTECNO®**  
 the modular gearmotor  
 www.transtecno.com